

# 1350 PH Screwdriver for Phillips screws, PH 1 x 80 mm

Kraftform Comfort



<b>EAN:</b>	4013288109286	<b>Size:</b>	178x33x33 mm
<b>Part number:</b>	05031441001	<b>Weight:</b>	58 g
<b>Article number:</b>	1350 PH	<b>Country of origin:</b>	CZ
		<b>Customs tariff number:</b>	82054000

- Kraftform Comfort screwdriver for cross-recess screws, Phillips
- Multi-component Kraftform handle for fast and ergonomic screwdriving
- Handle markings simplify finding and sorting of tools
- Hexagonal anti-roll feature against rolling away
- The Wera Black Point tip offers an exact fit and optimum corrosion protection

High quality Kraftform Comfort screwdriver with circular blade for cross-recess screws. Multi-component Kraftform handle for fast and low-fatigue working. The Wera Black Point tip and a complex hardening process ensure a long service life of the tip, enhanced corrosion protection and an exact fit. The hexagonal anti-roll feature prevents any bothersome rolling away at the workplace. Handle markings for simplified finding and sorting of the tool.



## Web link

[https://products.wera.de/en/screwdrivers\\_kraftform\\_comfort\\_1350\\_ph.html](https://products.wera.de/en/screwdrivers_kraftform_comfort_1350_ph.html)

Wera - 1350 PH  
05031441001 - 4013288109286

Wera Werkzeuge GmbH  
Korzter Straße 21-25  
D-42349 Wuppertal  
Tel: +49 (0)2 02 / 40 45-0  
E-Mail: [info@wera.de](mailto:info@wera.de)

Kraftform Comfort

Kraftform Comfort Handle



The ergonomic introduction to convenient screwdriving. Handle with Kraftform geometry and blade made from power bit material with Black Point tip for precise fit.



The multi-component Kraftform handle for quick and low-fatigue working.

Identification marking



The screw symbol and tip size identification markings on the handle make it easier to find the right screwdriver in the tool case, or at the workplace.

Non-roll feature

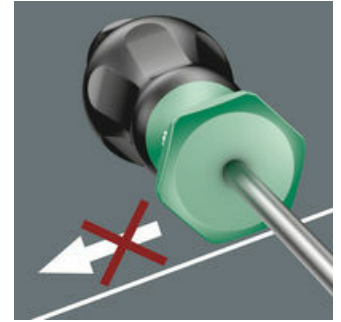

The hexagonal non-roll feature prevents any rolling away at the workplace.

Longer product service life

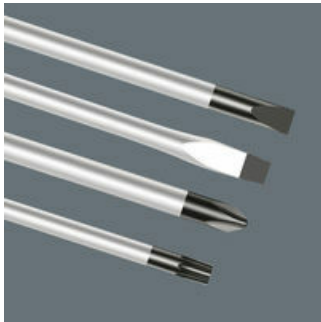

The bit material used for manufacturing is subjected to a specific Wera hardening process, and this ensures longer product service life.

Wera Black Point tip

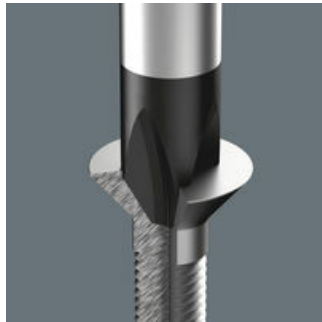

The Wera Black Point tip and a refined hardening process ensure long service life of the tip, improved corrosion protection and an exact fit.

Further versions in this product family:

		mm	mm	mm	inch
05031440001	PH 0	60	81	3.0	2 3/8
<b>05031441001</b>	<b>PH 1</b>	<b>80</b>	<b>98</b>	<b>4.5</b>	<b>3 1/8</b>
05031442001	PH 1	200	98	4.5	8
05031444001	PH 2	100	105	6.0	4
05031445001	PH 2	200	105	6.0	8
05031447001	PH 3	150	112	8.0	6

Web link

[https://products.wera.de/en/screwdrivers\\_kraftform\\_comfort\\_1350\\_ph.html](https://products.wera.de/en/screwdrivers_kraftform_comfort_1350_ph.html)

Wera - 1350 PH  
05031441001 - 4013288109286

Wera Werkzeuge GmbH  
Korzter Straße 21-25  
D-42349 Wuppertal  
Tel: +49 (0)2 02 / 40 45-0  
E-Mail: info@wera.de